



EC Axial Fans

- Motor Design : EC Technology
- Housing : Aluminium Die - cast
- Impellor : PBT (Polybutylene Terephthalate)
- Bearing : Sleeve or Ball Bearing
- Operating Voltage : 230V (185 - 245 VAC)
- Dielectric Strength : AC 500V for 1 minute
- Insulation : Class B
- Insulation Resistance : Above 10M Ohms at 500 VDC
- Connection : **T = Terminal**
- Motor Protection : Via Electronics
- Operating Temperature : - 10 to +70°C for Sleeve Bearing
- 20 to +70°C for Ball Bearing
- Net Weight : 310 Grams (Aluminium Housing)

120 x 120 x 38 mm



Specification

Model	Bearing	Voltage	Frequency	Current	Input Power	Speed ±5 %	Air Flow	Static Pressure	Noise
EC		V	Hz	A	W	RPM	CFM	mm H ₂ O	dB(A)
EC - 12038 A2 M T - 02	Sleeve	230	50/60	0.07	5.5	2700	105	7	43
EC - 12038 B2 M T - 02	Ball	230	50/60	0.07	5.5	2800	110	7.4	43

Note : * 02 = Aluminium Body M = Medium Speed T = Terminal

Also Available in 115 VAC

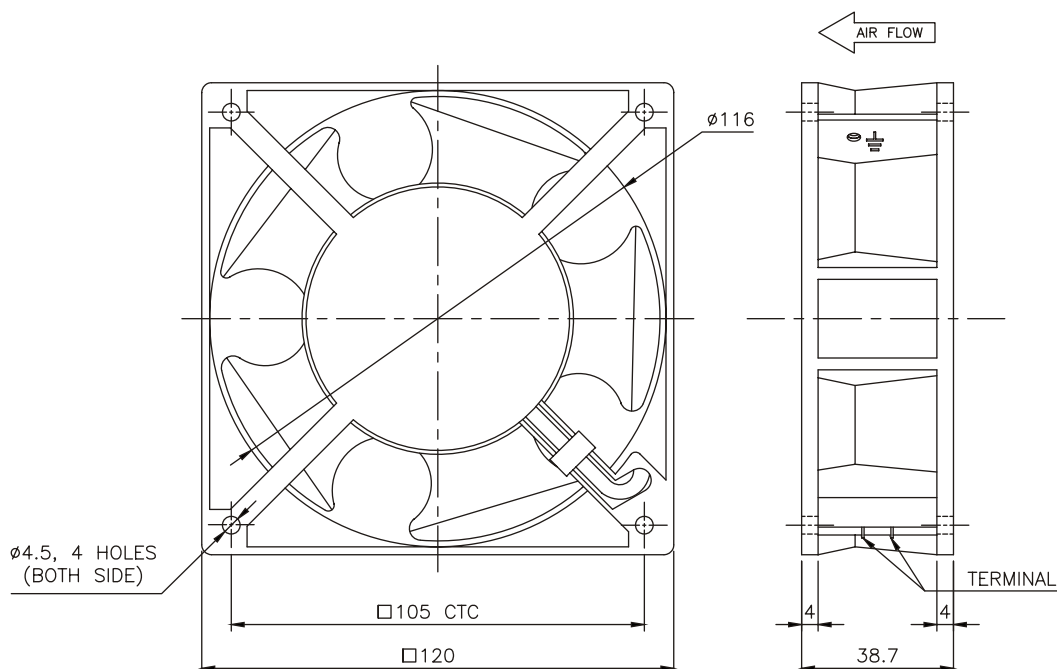

* Specifications Subject to Change Without Notice